



## AccuGuard GD11S Surface Mount Safety Beam



**Product Name**  
**AccuGuard GD11S**  
Surface Mount Safety Beam

**Manufacturer**  
MS SEDCO  
8701 Castle Park Drive  
Indianapolis, IN 46256  
Phone: (800) 842-2545  
www.mssedco.com

### Product Description

#### BASIC USE

The GD11S is a self-contained surface mount active infrared safety beam system for interior or exterior use on any automatic pedestrian door, industrial door or gate.

When the infrared beam is interrupted, the GD11S' relay output signals an industrial door or gate control to open, stop or reverse. On pedestrian swing doors, the GD11S is mounted on the guide rails. When the door is closing and the overhead safety sensor is locked out, interrupting the GD11S beam will bring this sensor protecting the swing side of the door back into the safety circuit thus inhibiting the door from reopening. This is now a requirement of ANSI A156.10 2005.

In the event of a power loss to the GD11S, the relay changes state (failsafe). The GD11S can be ordered with the GDB quick mounting brackets for easy installation on industrial doors and gates.

### Technical Data

- Economical
- Easy To Install and Maintain
- Simple To Align
- 12V To 24V AC or DC Operation
- Pulsed IR Emitter For High Immunity To Ambient Light
- Built-In Time Delay
- Weather Resistant Enclosure
- Rugged Construction
- Quick Mount GDB Bracket Available

### SPECIFICATIONS

<i>Model</i>	GD11S
<i>Physical Dimensions</i>	5 3/4"L x 1 1/2"W x 1 1/2"D
<i>Detection Method</i>	Active Infrared Beam Interrupt
<i>Detection Range</i>	0 to 40 feet
<i>Power Requirements</i>	12V to 24V AC or DC
<i>Current Draw</i>	
RX	75mA @ 12V DC
TX	60mA @ 12V DC
RX	100mA @ 24V DC
TX	60mA @ 24V DC
<i>Power Consumption</i>	
RX	2.4 Watts Max. @ 24V DC
TX	1.5 Watts Max. @ 24V DC
<i>Relay Contacts</i>	Form C Contacts Rated @ 1 Amp
<i>Relay Activation Time</i>	0.05 seconds
<i>Relay Hold Time</i>	0.5 to 5.0 sec.

### Temperature

0 °F to 140 °F (-18 °C to 60 °C)

### DIMENSIONS

See Reverse

### APPLICABLE STANDARDS

American National Standards Institute (ANSI) - Building Hardware Manufacturers Association (BHMA) - ANSI/BHMA A156.10.

### Installation

Refer to MS SEDCO Installation Instructions.

### Availability & Cost

#### AVAILABILITY

Available internationally from manufacturer's authorized distributors; contact MS SEDCO for the location of the nearest distributor.

#### COST

Cost information on MS SEDCO products is available from the manufacturer's authorized distributors.

### Warranty

MS SEDCO, Inc. guarantees this product to be free from manufacturing defects for one year from date of installation. Unless MS SEDCO is notified of the date of installation, the warranty will be in effect for one year from the date of shipment from our factory. If, during the first year, this product fails to operate and has not been tampered with or abused, the unit can be returned prepaid to the factory and be repaired free of

## AccuGuard GD11S Surface Mount Safety Beam



SENSORS & SWITCHES

### Warranty (continued)

charge. After one year, the unit will be repaired for a nominal service charge. **Limited warranty is in lieu of all other warranties, expressed or implied, including any implied warrantability of merchantability. No representative or person is authorized to assume for MS SEDCO any other liability in connection with the sale of our products. All warranties are limited to the duration of this written limited warranty. In no event shall MS SEDCO be liable for any special, incidental, consequential or other damage arising from any unclaimed breach of warranty as to its products or services.**

### Maintenance

MS SEDCO recommends that all maintenance and adjustments be performed by an AAADM Certified Technician.

### Technical Services

MS SEDCO's staff of factory trained sales and service personnel offer design assistance and technical support. Local distributors are also available to assist in selecting appropriate devices for specific uses and to provide onsite installation.

### DIMENSIONS

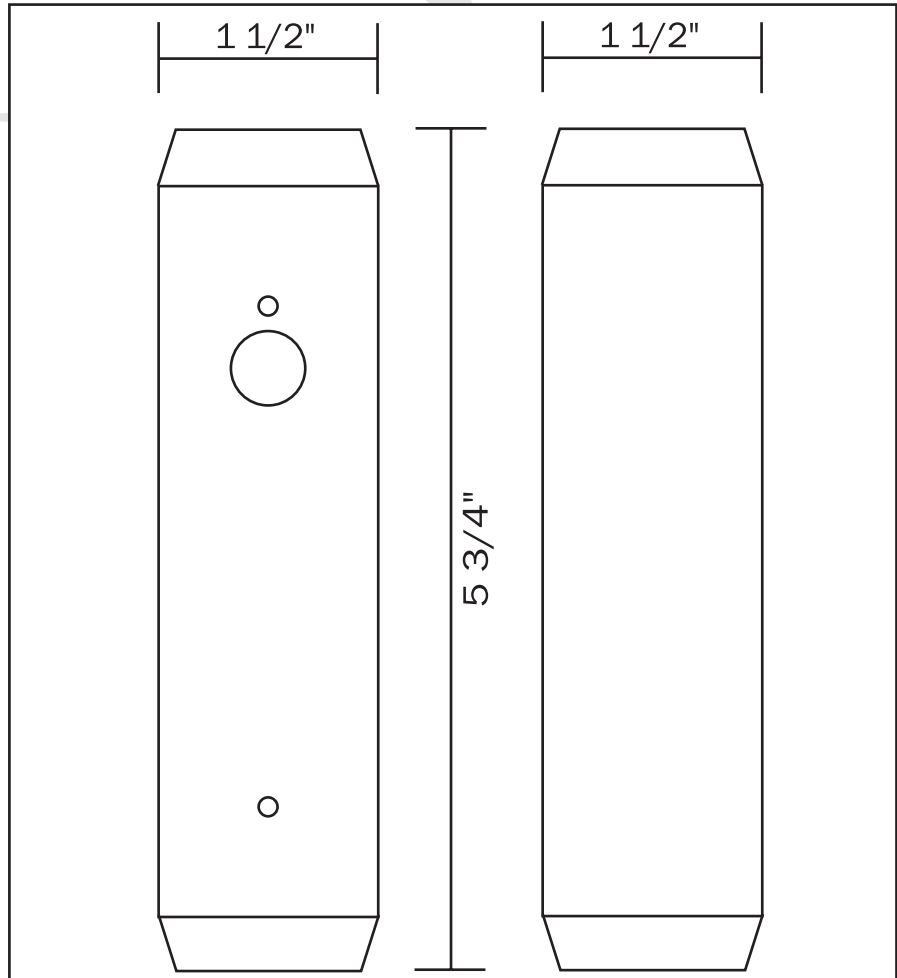

### GDB BRACKET

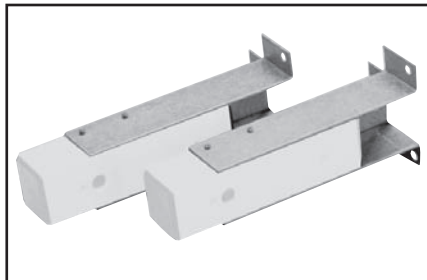

Ordering Options:  
GD11-GDB  
(Includes GD11S & GDB)  
GD11S Only  
GDB Only

22006